



Facebook

## Rubber Valve Seat

JT.1031.A.00-JT.1031.A.02

### General characteristics

#### General Definition

For supporting the fully closed position of the rubber valve, and form a sealing pair, prevent media leakage.

#### Working Principle

Uses a flexible sealing material and small actuator thrust to obtain a bubble tight seal, compress valve seat sealing stress elastically deforms the material and squeezes into rough surfaces of metal parts to block all leak paths. The permeability of the material is the basis for a small amount of leakage for the fluid

#### Description of Use

It is suitable for being installed on a variety of machinery and equipment, and it can play a role of sealing under static or moving state in the specified temperature, pressure, and different liquid and gas media.

### Design and Assembly

#### Feature

JT.1031 series is designed as a high compression strength rubber part.

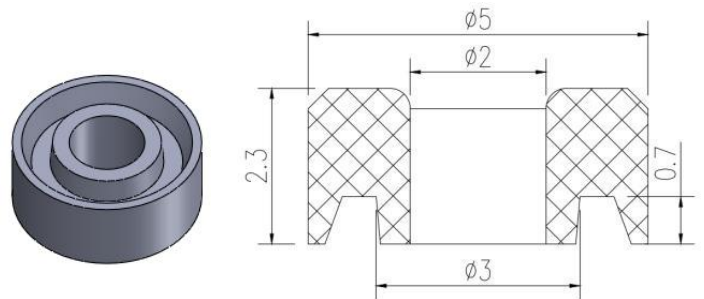

#### Mount Instructions

Mounted by squeezing 15%-20% of valve thickness, please contact Jingteng for Mounting instructions

### Available product Model

Part Number	Material	Color	Availability
JT.1031.A.00	NBR	Customize	Sample & Lot
JT.1031.A.01	FKM	Customize	Sample & Lot
JT.1031.A.02	FVMQ	Customize	Sample & Lot

